

User Manual

Degreaser Tray 90Ltr

Type PW20E



Read this manual carefully before using the degreaser tray.

Table of contents	Page
1.Safety & risk prevention	
1.1 General information	3
1.2 Safety instructions	4
1.3 Symbols	5
2.Assembly & installation	
2.1 Montage	6
2.2 Installation	6
2.3 Filling & commissioning	7
2.4 Use	7
3. Safety	
3.1 Fire safety	7
4.Maintenance & inspection	7
5.Environment & disposal	7
6.Technical data	
6.1 Parts	8
6.2 Parts list	9
7.Official documents	
7.1 Warranty	10
7.2 EC Declaration	11

1.1 General information

Keeping the user manual

Keep this user manual in a safe place. The information in this document may be necessary for installation, operation, maintenance, or troubleshooting. Keep this manual accessible at all times for future reference. This user manual contains important safety instructions and legal information. Keep this document for the entire life of the product. Always provide this manual if the product is resold, transferred, or relocated. It is mandatory to keep this user manual in a centrally accessible location. Personnel who work with this product must have access to the most recent version of this documentation at all times.



Dispose of electrical appliances in an environmentally friendly manner. Do not dispose of electrical appliances with household waste. In accordance with European Directive 2012/19/EU on electronic appliances, they must be collected separately for recycling. Contact your local authorities for available disposal options for your worn-out appliance.

© 2025 Mammuth All rights reserved. No part of this publication may be reproduced, stored in a retrieval system, or transmitted in any form or by any means without the express prior written permission of the publisher, except in cases where legally permitted.

1.2 Safety instructions

Use this product only as described. Incorrect use may result in serious injury and/or damage.

Prohibited / not allowed

Do not use near open flames, sparks, heat sources or other ignition sources.

- Do not smoke during use.
- Do not use in poorly ventilated areas.
- Do not use with flammable solvents.
- Do not leave unattended with lid open.

Obligated

Always wear: gloves, safety glasses, suitable work clothing.

- Use only suitable cleaning fluid with a sufficient flash point.
- Guidance: No liquid with a flash point below $< 150^{\circ}\text{F} / 65.6^{\circ}\text{C}$.
- Only fill to just below the rim / below the parts shelf (do not overfill).

Important

The spring/lid system is designed to hold the hood open during use.

- **Always close after use.**
- **Prohibited: leaving the degreaser container open unattended.**

Caution! The degreaser tray is intended for cleaning/degreasing parts with a suitable (preferably water-based), non-aggressive cleaning fluid with a flash point above 66.5°C . The fluid is circulated via a pump and nozzle/outlet.

1.3 Symbols



Do not use near open flames, sparks, heat sources or other ignition sources.



Do not smoke during use



Do not use in poorly ventilated areas



Do not use with flammable solvents



Mandatory use of safety glasses and gloves

2.1 Montage

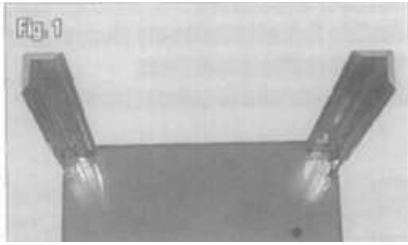

1. Place the tub upside down on cardboard/carpet. See image 1.
2. Assemble the 4 legs with bolts/washers and nuts.

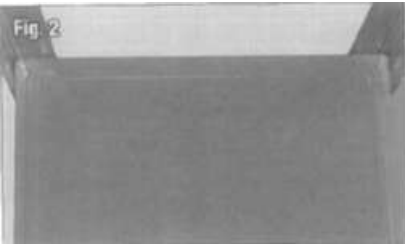

3. Assemble the platform. See image 2.



4. Stand the unit upright and open the lid.
5. Install the flexible spout onto the pump outlet and place the pump cover correctly

2.2 Installation

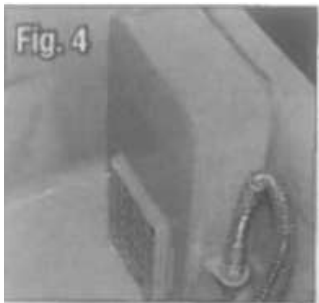

1. Check that the switch is accessible from outside and that the cable is free. See images 4 & 5.

2. Check that the drain plug is properly secured.



3. Place the grille and point the nozzle inward. See image 6

*brush and hose are optional accessories BPW5

2.3 Filling & commissioning

- 1.Fill with a suitable fluid until just below the parts shelf. We recommend EUROL HF Plus.
- 2.Make sure that the pump inlet is sufficiently submerged in liquid.
- 3.Connect to a grounded outlet.
- 4.Turn the switch to ON.

2.4 Use

- 1.Open the lid and turn on the pump.
- 2.Clean parts under the nozzle.
- 3.Let the parts drain on the rack.
- 4.Pump off → close lid → unplug.
- 5.Clean up spilled liquid immediately.

3.1 Fire safety

- The lid holder contains a fuse that will close the lid in the event of a fire. This fuse is not resettable and must be replaced after activation.
- Do not place the unit near open flames, sparks or other flammable conditions.
- Closing the lid can limit the spread of fire.
- Make sure that appropriate fire extinguishing equipment is available at the degreaser tank.
- Close the lid after each use.

4.Maintenance & inspection

- Always unplug before maintenance/cleaning.
- Clean the pump filter regularly (according to the instructions).
- Do not allow the fluid level to drop below the pump inlet.
- Repair/parts: only by authorized personnel and with original parts.
- Check regularly that all moving parts of the lid are functioning properly and that the lid can move freely without any blockages.
- Do not make any modifications to the lid, spring mechanism, or fusible link.
- Do not place any objects in or on the container that could prevent the lid from closing (completely).

6.1 Parts

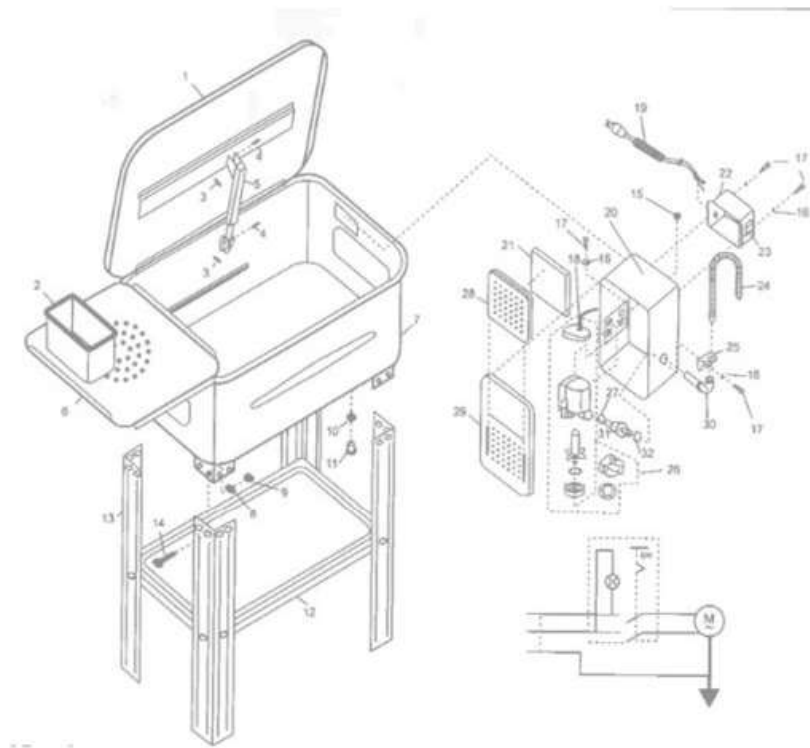

1. Lid
2. Parts tray
3. Pin spring
4. Pin
5. Hinge with thermal fuse
6. Grate
7. Tank
8. Washer
9. Nut
10. O-ring
11. Drain plug
12. Shelf
13. Leg
14. Bolt
15. Nut
16. Washer
17. Screw
18. Connector

19. Power cable
20. Pump housing
21. Filter
22. Control cabinet
23. On/off switch
24. Flexible hose
25. Mounting bracket
26. Complete degreaser pump
27. Washer
28. Filter lid
29. Front plate
30. Elbow fitting
31. Adapter
32. Washer

6.2 Parts list

1.	PPW20E-01	Lid
2.	PPW20E-02	Parts tray
3.	PPW20E-03	Spring Pin
4.	PPW20E-04	Pin
5.	PPW20E-05	Hinge with thermal fuse
6.	PPW20E-06	Grate
7.	PPW20E-07	Tank
8.	PPW20E-08	Washer
9.	PPW20E-09	Nut
10.	PPW20E-10	O-ring
11.	PPW20E-11	Drain plug
12.	PPW20E-12	Shelf
13.	PPW20E-13	Leg
14.	PPW20E-14	Bolt
15.	PPW20E-15	Nut
16.	PPW20E-16	Washer
17.	PPW20E-17	Screw
18.	PPW20E-18	Connector
19.	PPW20E-19	Power Cable
20.	PPW20E-20	Pump housing
21.	PPW20E-21	Filter
22.	PPW20E-22	Control cabinet
23.	PPW20E-23	On/off switch
24.	PPW20E-24	Flexible hose
25.	PPW20E-25	Mounting bracket
26.	PPW20E-26	Complete degreaser pump
27.	PPW20E-27	Washer
28.	PPW20E-28	Filter lid
29.	PPW20E-29	Front plate
30.	PPW20E-30	Elbow fitting
31.	PPW20E-31	Adapter
32.	PPW20E-32	Washer

7.1 Warranty

- 1.The warranty takes effect on the date stated on the purchase receipt and is valid for 12 months.
- 2.The warranty is not transferable without written permission from your supplier.
- 3.No warranty claim can be made without a purchase receipt.
- 4.The warranty only applies if the product is used in accordance with the instructions supplied and exclusively for the purpose for which it was designed.
- 5.No changes may be made to the product.
- 6.The warranty does not apply in case of improper use.
- 7.Any shipping costs are not covered by the warranty.
- 8.Repairs should be carried out exclusively by your supplier. Any repairs performed by third parties will void your warranty.
- 9.Repairs made during the warranty period will not extend the warranty period. However, a three-month warranty on repairs is provided if the regular warranty expires.
- 10.Any maintenance work to be carried out, as described in the operating instructions, must be carried out in a timely manner.
- 11.For warranty claims, please contact the point of purchase where you purchased the item.

**EG-verklaring van overeenstemming - Declaration of conformity –
Konformitätsverklärung - Declaration de conformite - Dichiarazione di
conformita- Declaracion de conformidad**

Wij, We,Wir,Nous,**Valkenpower BV, Haverkamp 11, 6051 AC Maasbracht, Nederland**, verklaren geheel onder eigen verantwoordelijkheid dat de producten, declare under our sole responsibility that the products, erklären in voller eigener Verantwortung, dass die Produkte, déclarons sous notre entière responsabilité que les produits

Type Model Art Type	Beschrijving Description Beschreibung Description	Merk Brand Marke Marque
PW20E	Ontvetterbak 90ltr	Mammuth
PW20E	Degreasing tank	Mammuth
PW20E	Entfettungswanne	Mammuth
PW20E	Cuve de dégraissage	Mammuth

Waarop deze verklaring betrekking heeft, in overeenstemming zijn met de volgende normen:To which this declaration relates, are in conformity with the following standards:Auf die sich diese Erklärung bezieht, den folgenden Normen entsprechen:Auxquels la présente déclaration se rapporte, sont conformes aux normes suivantes

De machinerichtlijn: Following the provisions of Directive: Gemäß den Bestimmungen der Richtlinie: Conformément aux dispositions de la Directive:
2006/95/EG

Directeur Valkenpower



B.A.H Valkenburg

Nederland, Maasbracht, 05-04-2018