

VALKENPOWER



User Manual Petrol Generator Model EMI2300



Please review this manual thoroughly prior to operating the generator.

Table of Contents	Page
1. Safety and Risk Mitigation	
1.1 Warnings	4
1.2 Safety Guidelines	5
1.3 Symbols	6 - 7
1.4 Overview	8
2. Utilize prior to commencement	
2.1 Scope of Application	9
2.2 Pre-Operational Inspection	10
2.3 Regulatory Functions	11 - 13
3. Utilizing the device	
3.1 Initiating the engine	14
3.2 Engine Shutdown	15
3.3 Alternating Current Applications	16
3.4 Proper Utilization of DC Output	17
4. Maintenance and Service	
4.1 Maintenance	18
4.2 Maintenance of Spark Plugs	19
4.3 Modifying the carburetor	20
4.4 Replacing Engine Oil	20
4.5 Air Filtration System	20 - 21
4.6 Exhaust Mesh and Spark Collector	21
4.7 Fuel Reservoir	22
4.8 Replacing the carburetor for high-altitude applications	22
5. Storage	
5.1 Fuel Drainage	23
5.2 Motor Storage	23
6. Troubleshooting and Technical Information	
6.1 Troubleshooting	24
6.2 Specifications	25
6.3 Parts	26
6.4 Components Inventory	27
7. Control Panels and Schematics	
7.1 Operation of the DC panel at 230V	28
7.2 Wiring Diagram 220V-50Hz	29
8. Authorized documents	
8.1 Warranty	30
8.2 EC Declaration	31

Maintaining the user manual

- Store this manual in a secure location. The information contained within this document may be essential for installation, usage, maintenance, or troubleshooting. Ensure this manual is readily available for future reference.
- This user manual includes essential safety instructions and legal information. Please keep this document for the entire lifespan of the product. Always include this manual if the product is resold, transferred, or relocated.
- It is essential to maintain this user manual in a centrally accessible location. Employees utilizing this product must have continuous access to the most current version of this documentation.

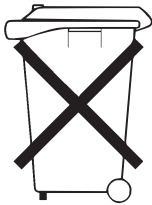

Dispose of electrical appliances in an environmentally responsible manner. Do not discard electrical appliances with regular household waste. In compliance with European Directive 2012/19/EU regarding electronic devices, these items must be collected separately for recycling. Please reach out to your local authorities for information on disposal options for your obsolete appliance.

© 2025 Valkenpower. All rights reserved. No portion of this publication may be reproduced, stored in a retrieval system, or disseminated in any form or by any means without the explicit prior written consent of the publisher, except where legally permitted.

1.1 Warning

- When integrating the generator into your home's electrical system, ensure that this task is performed by a qualified electrician. An improper connection between the generator and the loads may result in damage, burns, or fire hazards to the generator.
- Position the generator a minimum of 1 meter away from buildings or other equipment while in operation.
- Never operate the generator when it is suspended or inclined. The generator must be utilized and stored exclusively in an upright position.
- Ensure that you can swiftly deactivate the generator and are familiar with its operation.
- Avoid cigarettes, smoke, hot objects, and sparks during refueling.
- Always refuel in a well-ventilated space and with the engine turned off.
- Gasoline is highly flammable and can be explosive under specific conditions.
- Promptly clean up any spilled gasoline.
- Improper utilization of the generator may lead to electric shock; always avoid operating the generator with wet hands.
- Avoid operating the generator in rain or snow, and ensure it remains dry.
- Disconnect all connected devices prior to starting or stopping the generator to avoid potential equipment damage.
- Engine exhaust emissions are hazardous. The generator should be utilized exclusively in outdoor settings.
- Protection against electrocution relies on fuses specifically engineered for the generator. When a fuse requires replacement, the new fuse must possess identical properties and performance characteristics as the one being substituted.
- Given the significant mechanical stresses, utilize only an extension cord that complies with national standards.
- When utilizing extension cords or mobile distribution networks, a cable with a cross-section of 1.5 mm² should not exceed 60 meters in length. Conversely, a cable with a cross-section of 2.5 mm² has a maximum permissible length of 100 meters.
- Before operating the generator, ensure that there are no loose tools or materials present on it.
- To mitigate electrical interference, it is essential to ground the gasoline generator set.

1.2 Safety Guidelines

- Thoroughly review all instructions in this manual prior to utilizing the product.
- Always adhere to the specified procedures and cautionary symbols.
- Utilize the product solely for its intended purpose.
- Utilize suitable personal protective equipment when necessary.
- Never use the product while under the influence of alcohol, drugs, or medications that impair alertness.
- Do not permit individuals without adequate knowledge or experience to operate the product unless they are under the supervision of a qualified individual.
- Always adhere strictly to the instructions outlined in the manual without making any unauthorized adjustments or modifications.
- Maintain a safe distance between hands and other body parts from moving, hot, or pressurized components.
- Utilize the product exclusively in a clean, dry, and well-illuminated environment.
- Ensure sufficient ventilation during use.
- Maintain a clear work area, free from obstacles and loose items.
- Ensure that children and unauthorized individuals are kept away from the work area.
- Verify that the supply voltage aligns with the product specifications.
- Utilize exclusively original replacement components.
- Deactivate the product and disconnect it from the power or pressure source prior to undertaking any adjustments, cleaning, or repairs.
- Repairs for defects should be conducted exclusively by an authorized technician.
- Cease use immediately upon noticing any unusual noise, odor, or vibration.
- Immediately switch off the product in the event of malfunctions or hazardous situations.
- Always ensure that an appropriate fire extinguisher and first aid kit are readily accessible.
- Avoid using electrical equipment in damp or wet environments, refrain from exposing it to rain, and do not operate it in proximity to flammable liquids or gases.
- When not in use, tools should be stored out of reach.
- Maintain tool handles in a dry, clean condition, ensuring they are free from grease and oil.
- For outdoor use exclusively due to the risk of suffocation.

1.3 Symbols Label



Before use: Please read the instructions thoroughly.



Before use: Verify the oil and fuel levels.



Fuel-related: Refueling / Cap closure / Off position.



Avoid usage in enclosed spaces.
1. Avoid usage within a house or enclosed space.



Exhaust emissions contain toxic carbon monoxide.
Avoid inhaling.



Hot surface - May result in burns.

1.3 Symbols Label



Complies with the Euro V European emission standard.



Hearing protection is mandatory.



Fire hazard (flammable petrol).



Electrical voltage/shock hazard.



Prohibited: Smoking and open fires are not permitted.

1.4 Overview

- Before operating this machine, it is imperative to thoroughly read and comprehend the operating instructions. This manual contains essential information regarding the proper installation, operation, and maintenance of the equipment detailed herein. The use of any generator entails various risks of personal injury or property damage. Individuals involved in the installation, maintenance, or operation of the generator must be fully acquainted with the contents of this manual. To safeguard against personal injury or property damage, adherence to the directions and instructions provided in this manual is essential. Each Valkenpower generator is produced in compliance with the Machinery Directive 2006/42/CE. A manual, which includes a Declaration of Conformity, accompanies every generator. This manual should be preserved and maintained. Due to ongoing quality improvements, Valkenpower b.v. reserves the right to modify the specifications of the equipment described in this manual.

General safety guidelines for power tools

To utilize this product effectively, it is imperative to be acquainted with the safety regulations, assembly instructions, and operating guidelines outlined in this user manual. All individuals who use or operate the appliance must be familiar with this manual and aware of any potential hazards. Children and individuals with health issues are prohibited from using this appliance. Children must be supervised at all times when in proximity to the appliance. Adhering to the safety regulations is crucial to prevent accidents. The same holds true for regulations concerning health and safety in the workplace.

Warning

Mitigate the risk of fire, electric shock, and personal injury when operating the generator. Always adhere to the safety guidelines outlined in this manual.



Warning

When connecting a generator to the home mains supply, this must be performed by a qualified electrician in compliance with NEN 1010 (safety regulations for low-voltage installations) and NEN 3140 (safe practices for working on and with electrical installations).

An improper or unauthorized connection between the generator and the residential installation can result in severe injury, electric shock, fire, and irreversible damage to both the generator and the installation.

2.1 Scope of Application

The table below offers reference information for connecting electrical appliances to the generator.

Description	Wattage		peak demand	
	assets	powerfactor	startup zenith	ongoing power evaluation
	1000	x1	1000	1000
	1000	x1.5	1500	1000
	1000	x2	2000	1000

NOTIFICATION:

- Both AC and DC inputs may be utilized concurrently, with the total output power not to exceed the rated output power. Should the total output power surpass the rated output, the overload indicator light will activate.

Generator capacity

Nominal power of the AC generator	1800W
Peak power alternating current	1950W
Direct Current (DC) Power Output	12V/8A

NOTICE:

Do not exceed the load capacity. The cumulative wattage of the electrical equipment must not surpass Do not exceed the generator's output power; otherwise, the generator may sustain damage.

When utilizing this generator to power devices such as radio frequency inverters, electronic controllers, personal computers, microcomputers, and similar equipment, it is essential to maintain an adequate distance between the generator and the devices to mitigate electromagnetic interference from the motor. This practice also safeguards the motor from surrounding electronic devices. In instances where this generator is employed to power medical equipment, it is advisable to consult the equipment manufacturer, a qualified professional, or the hospital regarding the current requirements necessary to initiate specific electronic devices or general motors, as this may affect their operability. Even if the startup parameters align with the conditions outlined in the table above, it remains prudent to reach out to the equipment manufacturer.

2.2 Pre-Operational Inspection

Warning: The engine and exhaust reach elevated temperatures during operation. Refrain from inspecting or repairing them until they have cooled adequately. Ensure that no part of your body or clothing comes into contact with the engine or exhaust.

NOTICE: Please ensure you verify this prior to examining the items listed below.

Fuel

DANGER: Do not exceed the fill limit, as the tank will overflow when it warms up. After refueling, ensure that the cap is securely fastened.

NOTICE: After refueling, promptly wipe away any residual gasoline with a clean, soft cloth to avoid damage to the plastic casing. Only unleaded gasoline should be utilized, as leaded gasoline can cause significant harm to internal engine components. Remove the fuel cap and fill the tank to the maximum level. ②

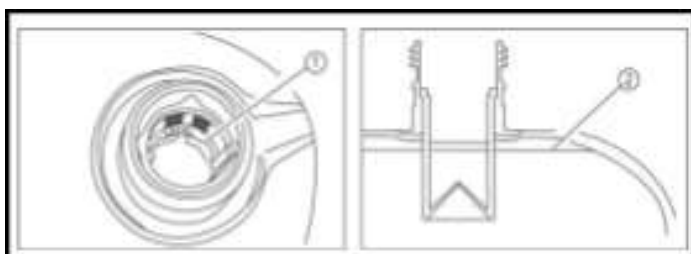

Rode indicator component;

② Fuel level.

Recommended fuel:

Unleaded petrol Full tank
capacity: 4 liters

Lubricating oil



1. Position the engine on a level surface.
2. Remove the end cap by rotating it to the "ON" position.
3. Inject the specified quantity of recommended oil.
4. Replace the sealing cap and rotate it to the "OFF" position.

This generator is provided without oil. Do not start the engine until it has been adequately lubricated.

Recommended SAE 10W-40
lubricant:

2.3 Regulatory Function

Three-in-one combination switch.

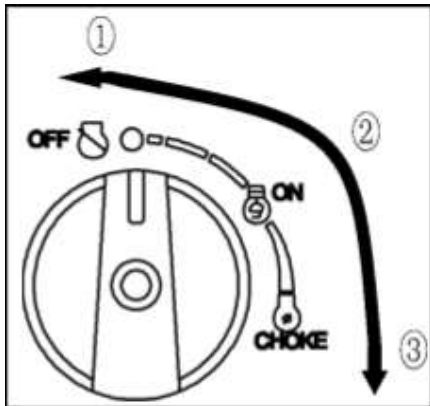

1. Engine and fuel switch in the "OFF" position:
2. The ignition circuit is closed, the fuel switch is turned off, and the engine fails to start.
3. Engine, fuel switch, and choke switch in the "ON" position:
4. The ignition line is functioning properly, the fuel switch is activated, and the choke is fully open, allowing for normal operation.
5. Engine, fuel selector, and choke control in "CHOKE" position:
6. The ignition line is functioning properly, the fuel-
7. The switch is activated, the choke is closed, and the engine can start as expected.

NOTICE: When the engine is warm, it is unnecessary to set it to the "CHOKE" position during startup.

Oil warning light (red)

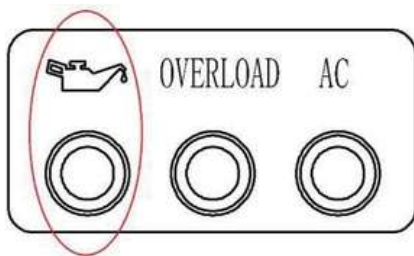

When the crankcase oil level falls below the safety threshold, the oil protection system automatically shuts down the engine, and the oil warning light activates. Refilling the oil to the appropriate level will restart the engine.

NOTICE: If the engine stalls or fails to start, turn the ignition switch to the "ON" position and then pull the starter handle. If the oil warning light blinks for a few seconds, it indicates insufficient oil. Add oil and restart the engine.

Overload alarm indicator light (red)

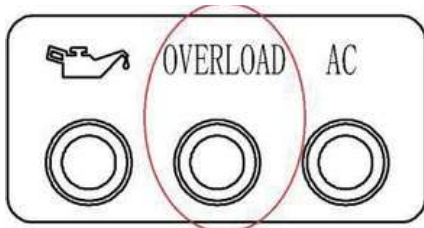

When the overload indicator illuminates, it signifies that the output of the connected loads is exceeding capacity, resulting in the inverter overheating. At this juncture, the AC protection system engages, and the generator ceases operation to safeguard both the generator and the connected electrical devices. If the AC indicator light (green) is off while the overload indicator light (red) is illuminated, the generator remains operational.

When the overload indicator illuminates and the device ceases to produce output, please take the following measures:

1. Disconnect and remove the connected electrical devices from the power source.
2. Decrease the overall power of the connected electrical devices to fall within the specified output range.
3. Inspect for any foreign objects obstructing the air intake and examine the associated control components for any irregularities. If an issue is identified, rectify it promptly.

After verification, press the voltage recovery button for 1 to 3 seconds to reinstate the output voltage.

NOTICE: When operating electrical equipment with high starting currents (such as compressors, submersible pumps, etc.), the overload indicator may illuminate for a few seconds initially. However, this does not necessarily indicate the aforementioned fault. Overload, short circuits, overheating, and low motor speed can all result in output cessation.

AC indicator light (Green)

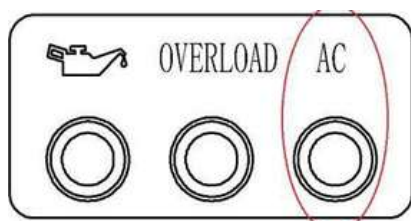

When the engine starts and operates normally, the AC indicator light will illuminate.

Indicator assessment:

- Green light illuminated: Signifies normal operation and generator output.
- Green light illuminated and red light flashing: Indicates overload, generator output.
- When the green light is extinguished and the red light blinks every three seconds, it signifies that the coil's front-end voltage is insufficient and the generator is devoid of power.
- When the green light is extinguished and the red light flashes twice within three seconds, it indicates that the engine speed is excessively low and the generator is not producing any output.
- When the green light is extinguished and the red light blinks three times within three seconds, it signifies that the generator's temperature is excessively high and that the generator is devoid of power.
- If the green light is off and the red light flashes five times within three seconds, this signifies that the coil voltage is excessively high and the generator is devoid of power.
- The green light is extinguished, and the red light blinks six times within three seconds, indicating overload protection and the absence of output.

DC protection

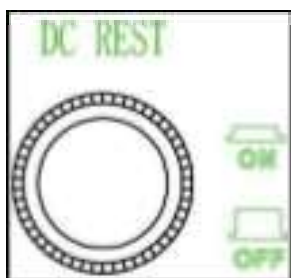

When the electronic equipment connected to the generator is in operation and the rated current is surpassed, the DC switch automatically transitions to the "OFF" position. To resume operation, simply return the DC switch to the "ON" position.

"ON": Standard DC output "OFF": No DC output.

NOTICE: If the DC protection is disabled, please reduce the load of the connected electronic equipment to match the generator's rated output. Should the DC protection remain disabled, cease using the electrical equipment immediately and contact your dealer.

ECO toggle



1. "ON" indicates that when the ECO switch is in the "ON" position, the energy-saving device will regulate the engine speed according to the connected load, resulting in improved fuel efficiency and reduced noise.
2. "OFF": When the ECO switch is in the "OFF" position, the engine operates at its rated speed of 3600 rpm, irrespective of load connection.

NOTICE: When operating the following equipment, such as an air compressor, the ECO switch must be disabled due to the requirement for a substantial starting current.

Voltage restoration button

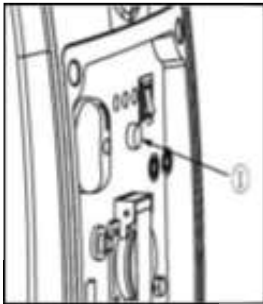

When the generator's overload indicator light illuminates, the generator produces no output voltage, yet remains operational. Disconnect all loads, then press the voltage restore button for 1-3 seconds to reinstate output voltage.

NOTICE: Upon recovery of the overload voltage, ensure that there is no load connection, no short circuit, and no other faults present before pressing the recovery voltage button.

Fuel tank cover



Rotate counterclockwise and detach the fuel cap.

Toothed cap air vent control button

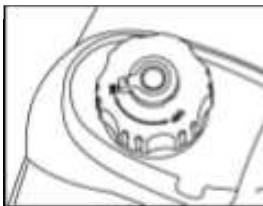

A vent knob is situated atop the fuel tank to regulate the flow of fuel. When the generator is operational, the vent knob must be in the "ON" position to allow fuel to be delivered to the carburetor, ensuring the engine continues to run. When the generator is not in operation, the vent knob should be turned to the "OFF" position to cease the flow of fuel.

Earth terminal (ground)

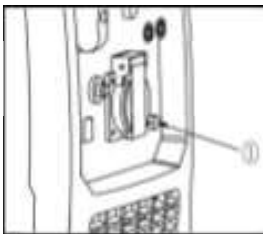

Exercise caution when connecting the grounding terminal to the grounding wire to prevent electric shock. If the electrical equipment is grounded, the generator must likewise be grounded.

3.1 Initiating the engine

Before starting the engine, verify that the oil pan is filled to the appropriate level. NOTE: The generator is not factory-primed; you must replenish the oil yourself prior to its initial use.



1. Activate the ECO switch by setting it to "ON."



2. Set the fuel cap ventilation knob to "ON."

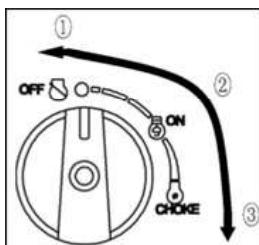

3. Select the three-in-one switch combination knob and rotate it to the "CHOKE" position.

- A) Activate the fuel.
- B) Activate the ignition system.
- C) Close the choke under normal operating conditions with a cold engine.

NOTICE: When the engine is warm, it is unnecessary to close the choke and switch the combination to the "ON" position.

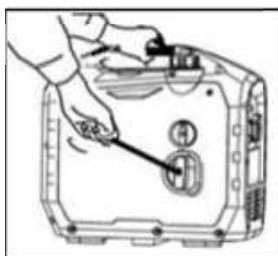

4. Gradually pull the starter rope until you encounter resistance, then pull it firmly. Do not let go of the starter rope; instead, gently guide it back to its original position and turn the combination switch to "ON." When starting the engine for the first time, repeat this procedure several times until fuel from the tank is delivered to the engine.

3.2 Engine Shutdown

NOTICE: Disconnect all connected electrical devices.



1. Switch the ECO setting to "OFF."

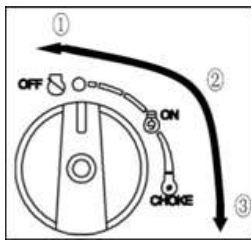

2. Select the three-in-one switch combination knob and rotate it to the "OFF" position.
 - A) Disable the fuel supply.
 - B) Disable the ignition system.

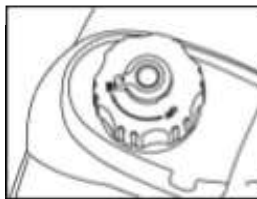

3. When the generator has cooled, turn the Set the vent button to "OFF."

3.3 Alternating Current Applications

NOTICE: Ensure that the appliance is properly grounded. All electrical devices must be disconnected before being plugged into the wall socket.

1. Ignite the engine.
2. Activate the ECO switch by setting it to "ON."
3. Insert the power cord into the electrical outlet.
4. Verify whether the AC indicator is illuminated.
5. Activate the electrical equipment.

NOTICE: Prior to increasing engine speed, ensure the ECO switch is set to the "OFF" position. If the generator is powering multiple loads or electrical devices, begin with the highest setting, contingent upon the size of the electrical equipment.

3.4 Proper Utilization of DC Output

NOTIFICATION:

The nominal direct current voltage of this generator is 12V.

Once the generator has been activated, connect the battery to the generator.

Ensure that the DC protection is activated prior to initiating the charging process.

Ensure that the red wire from the charger is connected to the positive (+) terminal of the battery, while the black wire is connected to the negative (-) terminal, not the other way around.

If the current surpasses the rated current during charging, the DC protector will disable the output. To resume charging, press the DC protector to the "ON" position.

If the DC protector activates again, cease charging and reach out to your dealer.

Activate the generator.

- Connect the red wire from the charger to the positive (+) terminal of the battery.
- Attach the black wire from the charger to the negative (-) terminal of the battery.

NOTIFICATION:

Measure the specific gravity or voltage of the electrolyte at +/- 13V to confirm that the battery is fully charged. When fully charged, the electrolyte's specific gravity ranges from 1.26 to 1.28.

It is advisable to monitor the specific gravity of the electrolyte at least once an hour to prevent overcharging the battery.

WARNING:

Refrain from smoking or connecting or disconnecting the battery during charging. The resulting spark may ignite the gas surrounding the battery. Battery electrolyte contains sulfuric acid, which is hazardous and can cause burns. Avoid contact with skin, eyes, and clothing.

Treatment: External contact - rinse thoroughly with water. Ingestion - consume ample amounts of water or milk, preferably milk containing magnesium oxide, eggs, or vegetable oil.

Call the hospital immediately. Eye penetration—rinse with water for 15 minutes and seek immediate medical attention.

Batteries can emit explosive gases. Maintain a safe distance from sparks, flames, cigarettes, and similar sources.

When utilizing batteries in a confined area, ensure proper ventilation. Close your eyes when operating in proximity to the battery. Keep the battery out of reach of children.

4.1 Maintenance

Proper maintenance serves as the foremost assurance for safe, economical, and trouble-free operation, while also contributing to environmental protection. Users must operate the machine with safety in mind. Regular inspection, adjustment, and lubrication are essential to ensure the generator operates safely and efficiently.

Understood. Please provide the text you would like me to update.

For further information, please reach out to your dealer.

Element	Action	Any utilization	First month or 10 o'clock	Every three months or 50 hours	Every six months or one hundred hours	Each year or 300 hours
motor oil	check	X				
motor oil	replace		X(1)		X(1)	
air filtration system	check	X				
air filtration system	replace			X(1.2)		
bougie	cleaning and adjustment				X	
spark arrestor	cleaning				X	
float chamber	cleaning				X	
valve adjustment	verify and modify					X(3)
fuel reservoir and filter	check					X(3)

Notification:

The generator should be serviced more frequently when it operates in a dusty or dirty work environment.

1. These components should be serviced by your dealer unless you possess the necessary materials and skills to perform the task independently.
2. For commercial purposes, monitor operating hours to determine when maintenance is necessary.

Warning: Prior to conducting any maintenance work, ensure the engine is turned off. The engine should be positioned horizontally, and the spark plug cap must be detached from the spark plug to prevent accidental starting. Avoid using indoors or in inadequately ventilated spaces, such as tunnels and caves. Confirm that the work area is adequately ventilated. Engine exhaust contains toxic carbon monoxide, which, if inhaled, can lead to shock, unconsciousness, and potentially fatal outcomes.

4.2 Maintenance of Spark Plugs

Spark plugs play a crucial role in the generator and should be inspected regularly.

1. Remove the outer cover and the spark plug cover. ① Detach the spark plug cover. ② Insert cover ④ into the hole from the exterior of the cover.
2. Insert the screwdriver ③ into the sleeve ④ and extract the spark plug by rotating it counterclockwise.

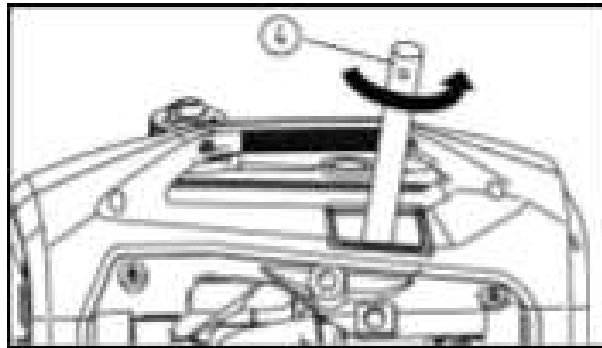
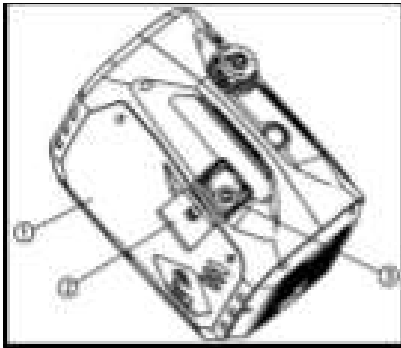

3. Examine the color for any signs of fading and eliminate any carbon deposits. The porcelain insulator surrounding the spark plug's central electrode should exhibit a moderately light brown hue.
4. Verify the type and clearance of the spark plug.

Standard spark plug: A5RTC
Spark plug gap: 0.7-0.8mm

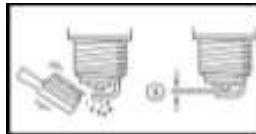

Tip: The spark plug gap should be assessed using a feeler gauge or thickness gauge and adjusted as needed.

5. Install the spark plug.
6. Install the spark plug cap and cover.

Tip: The spark plug must be tightened to the designated torque.

Torque : 22 N*m

4.3 Modifying the carburetor

The carburetor is a crucial component of the engine. It should be calibrated by a dealer utilizing expert knowledge and specialized equipment to ensure optimal tuning.

4.4 Replacing Engine Oil

Warning: Do not drain the oil immediately after the generator has been turned off. The oil temperature remains very high. Exercise caution during operation to prevent burns.

1. Position the generator on a level surface and operate it for several minutes to increase the temperature before shutting off the engine. Adjust the three-in-one combination knob. The fuel tank lid vent knob should be set to "OFF."
2. Rotate the oil port bulkhead lock lever and detach the oil port protector ①.
3. Remove the oil cap.
4. Position the oil pan beneath the engine, tilt the generator, and swiftly drain the oil.

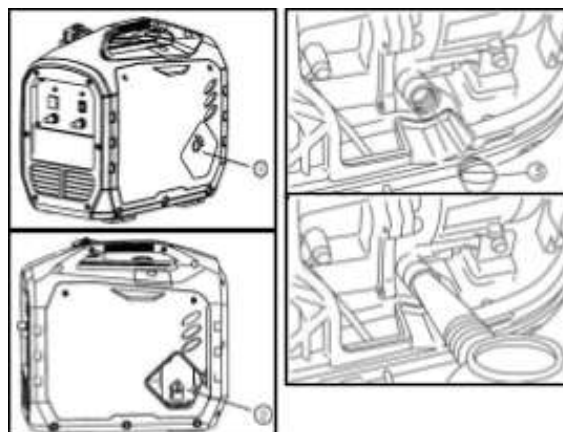

- Position the generator on a level surface.
- Refill the oil in the designated location.
- Clean the cap and remove any splattered oil.
- Secure the oil pan.
- Encase the exterior plate.

Engine oil: SAE 10W-40
Engine oil: API standard SE or higher
Cubage: 0.35L

Note: Avoid tilting the engine while adding oil to prevent excess oil from impacting the engine's performance. Ensure that no foreign objects infiltrate the engine housing.

4.5 Air Filtration System

1. Remove screw ① and outer plate ②.
2. Remove screw ③ and the air filter cover ④.
3. Eliminate the foam component ⑤.

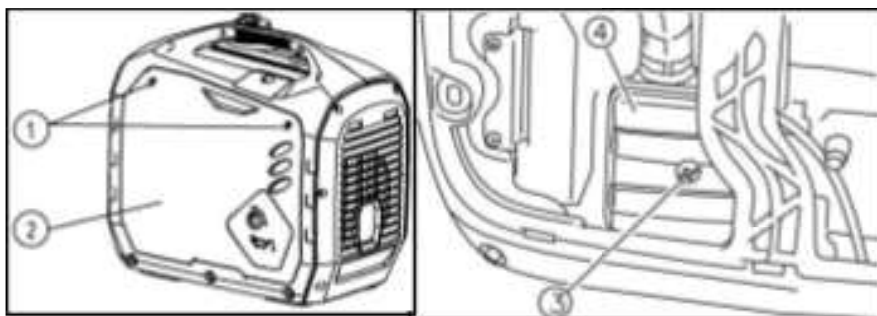

4. Clean the foam component with solvent and allow it to dry.
5. Apply oil to the foam element and expel the excess. The foam element should be damp, but no oil should leak out.
Caution: Do not rotate the foam component to prevent damage.
6. Insert the foam component into the air filter.
Tip: Ensure that the surface of the foam element is in close proximity to the air filter, with no gaps present. Avoid starting the engine without the filter installed, as this may lead to excessive throttle and cylinder wear.
7. Reinstall the air filter cover in its original position and secure the screw.
8. Replace the outer cover plate and secure the screw.



4.6 Exhaust Screen and Spark Arrestor

Warning: The engine and muffler may reach elevated temperatures after operation. Ensure that your skin and clothing are kept clear of the engine and muffler during inspection and maintenance.

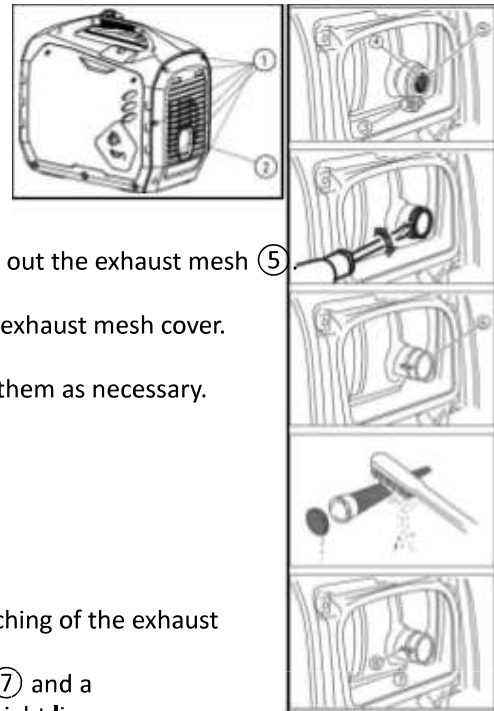

1. Remove screw (1), detach the rear sunshades (2).
2. Remove screw (3), detach the exhaust cover (4), and take out the exhaust mesh (5) and spark collector (6).
3. Utilize a wire brush to eliminate carbon deposits from the exhaust mesh cover and the spark collector.
4. Inspect the exhaust grille and spark collector, and replace them as necessary promptly if they are compromised.
5. Reinstall the spark collector.
6. Install the exhaust mesh cover and the rear of the muffler.
7. Replace the rear blinds and secure the screw.

Remark:

Clean meticulously with steel wire to prevent damage or scratching of the exhaust grille and spark collector.

- To ensure the optimal performance of the spark collector (7) and a
- A small hole in the exhaust pipe (8) is situated along a straight line.

4.7 Fuel Tank Filter

Warning: Avoid using gasoline in the presence of smoke or flames.

Remove the fuel tank cover and the filter.

- Clean the fuel tank filter using gasoline.
- Dry the strainer and return it to the fuel tank.
- Replace the fuel tank lid.

NOTE: Ensure the lid is fastened securely.

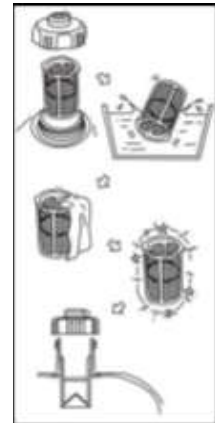

4.8 Replacing the carburetor for high-altitude applications

At elevated altitudes, the air intake volume of a standard carburetor diminishes due to reduced air pressure, leading to decreased performance and increased fuel consumption. A rich fuel mixture may also contaminate the spark plug, resulting in starting difficulties. Additionally, exhaust emissions may rise if the engine is operated at an altitude outside its specified range. If your engine consistently operates at high altitudes (greater than 1500 m), consult your dealer to have the carburetor adjusted to enhance engine performance. In this scenario, the modified carburetor will comply with all emissions standards for its operational lifespan.

5. Storage

If you intend to store this generator for an extended duration, certain precautions should be implemented to mitigate aging.

5.1 Fuel Drainage

1. Deactivate the three-in-one combination switch.
2. Open the fuel cap and detach the filter. Transfer all fuel from the tank to the designated container and resecure the fuel cap. Warning: The fuel tank is highly volatile and toxic. Please read the safety instructions thoroughly (refer to page _

Note: Utilize a clean, soft cloth to promptly wipe away any spilled oil. Take care to avoid damaging the plastic housing.

3. Start the engine (refer to page 18) and turn it off once the fuel is depleted, which will occur after approximately 20 minutes.
 - Avoid connecting any electrical devices
 - The duration of engine operation is contingent upon the quantity of fuel left in the tank.
4. Remove the screw and the outer cover panel.
5. Loosen the intake plug on the carburetor and allow the fuel to drain into the designated tank.
6. Set the three-in-one control switch to "START."
7. Secure the drain plug.
8. Replace the cover plate and secure the screw.
9. Once the engine has fully cooled, secure the vent knob on the fuel tank cap.

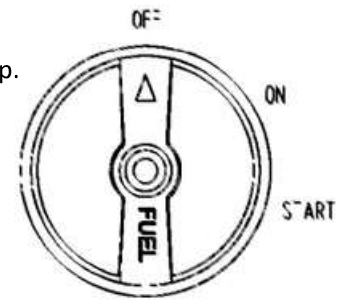

5.2 Engine Examination

Follow the steps below to safeguard the box, piston ring, and other components susceptible to corrosion.

1. Remove the spark plug, pour a spoonful of SAE10W40 oil into the cylinder, reinstall the spark plug, and engage the starter (ensuring the combination switch is closed) for several minutes to lubricate the cylinder block with the oil.
2. Engage the manual starter until you experience resistance (to avert rusting of the cylinder housing and valve).
3. Clean the surface, position the engine in a well-ventilated and dry area, and cover it with a protective cover.

6.1 Troubleshooting

The engine fails to start.

- Insufficient gasoline or oil
- Ignition switch set to the "OFF" position
- Damaged spark plug
- Choke in an incorrect position
- Devices connected during startup
- The spark plug cap is either loose or disconnected.
- Engine inundated
- Aged gasoline
- refill gasoline or oil
- Set to On position.
- Replace the spark plug.
- Adjust the choke to the appropriate setting (cold engine = choke, warm engine = run).
- Disconnect devices.
- Securely press the spark plug cap.
- Allow it to rest for 5-10 minutes and then attempt again as per the instructions. If this does not resolve the issue and the choke lever is in the Start position, try restarting with the choke lever in the Run position.
- Drain the old gasoline and refill with fresh gasoline.

DC power supply, no output

- The fuse has blown (applicable only to DC).
- Press the reset button or fuse.

The generator is operating with difficulty.

- Is the choke lever set to the Run position?
- Has the generator been inactive for some time, and could the gasoline be outdated?
- No - position the choke lever to the Run setting.
- If this is the situation, remove the old gasoline and replace it with fresh gasoline.

The generator is not producing any voltage output.

- Safety device (DC protector) in the "OFF" position
- AC indicator light (green) extinguished
- Press the DC protector to the "ON" setting.
- Stop the engine and then restart it. Alternatively, press and hold the voltage restore button for 1 to 3 seconds to reinstate the output voltage.

The generator is experiencing overheating.

- Generator overloaded.
- Inadequate ventilation
- Lower the tax.
- Reposition the generator to a cooler area.

6.2 Specifications

Max Power	1.95 kW
Rated Power (230V)	1.8 kW
Max Power (230V)	1.95 kW
Frequency	50 Hz
Output Voltage	230V
AC Output	230V / 16A (2-pole)
USB-A Output	5V / 1A, 5V /2.1A
Engine Model	148F
Engine Type	4-stroke, single cylinder, OHV (overhead valve)
Engine Speed	4800 rpm
Number of Cylinders	1
Cylinder Capacity	80 ml
Cooling System	air cooled
Starting System	manual
Fuel Type	Petrol
Tank Capacity	4 L
Fuel Consumption at 50% Load	0.8 L/h
Fuel Consumption at 100% Load	1.2 L/h
Oil Type	015W40
Oil Capacity	0.35 L
Noise Level	62 dB

Generatorset

LXBXH/mm	486*295*453
Net weight/kg	19.4

6.3 Parts

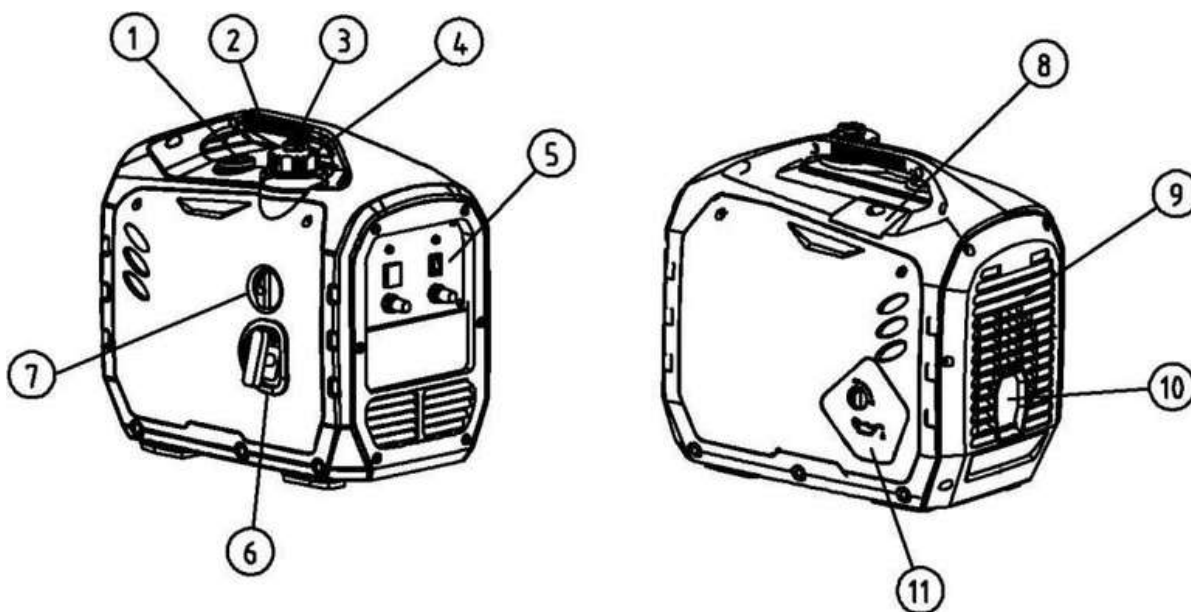

1. Spark plug maintenance coverage
2. Fuel cap ventilation button
3. Fuel tank cover
4. Carrying handle
5. Control interface
6. Startgreep
7. 3-in-1 switch (start button, fuel selector, and choke control)
8. Spark plug maintenance coverage
9. Rear window shades
10. Exhaust installation
11. Cover plate

6.4 Components Inventory

- | | | |
|-----|-------------|--|
| 1. | PEMI2300-1 | Spark Plug Service Cover |
| 2. | PEMI2300-2 | Fuel Cap Vent Button |
| 3. | PEMI2300-3 | Brandstoftankdop |
| 4. | PEMI2300-4 | Transport handle |
| 5. | PEMI2300-5 | Control Panel |
| 6. | PEMI2300-6 | Startgreep |
| 7. | PEMI2300-7 | 3-in-1 switch button (activation button, fuel switch and choke switch) |
| 8. | PEMI2300-8 | Spark Plug Service Cover |
| 9. | PEMI2300-9 | Rear window shades |
| 10. | PEMI2300-10 | Exhaust Bracket |
| 11. | PEMI2300-11 | Oil Port Bulkhead |

7.1 Operation DC Panel 230V - 50Hz

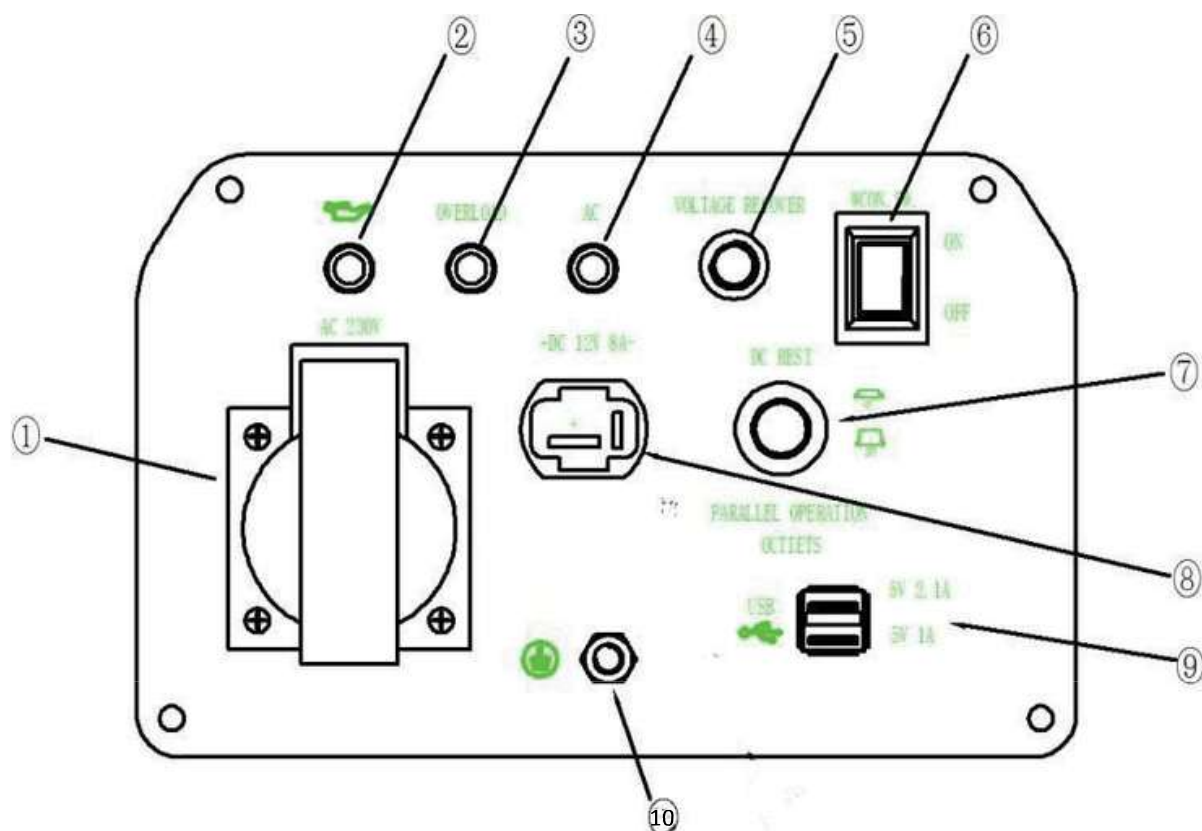

1. AC connection
2. Oil pressure warning light (red)
3. Overload alarm indicator light (red)
4. AC indicator light (emerald)
5. Voltage restoration button
6. Energy Conservation Switch (ECS)
7. DC protection
8. DC connection
9. USB interface
10. Earth terminal (ground)

7.2 Wiring Diagram - AC 220V 50Hz

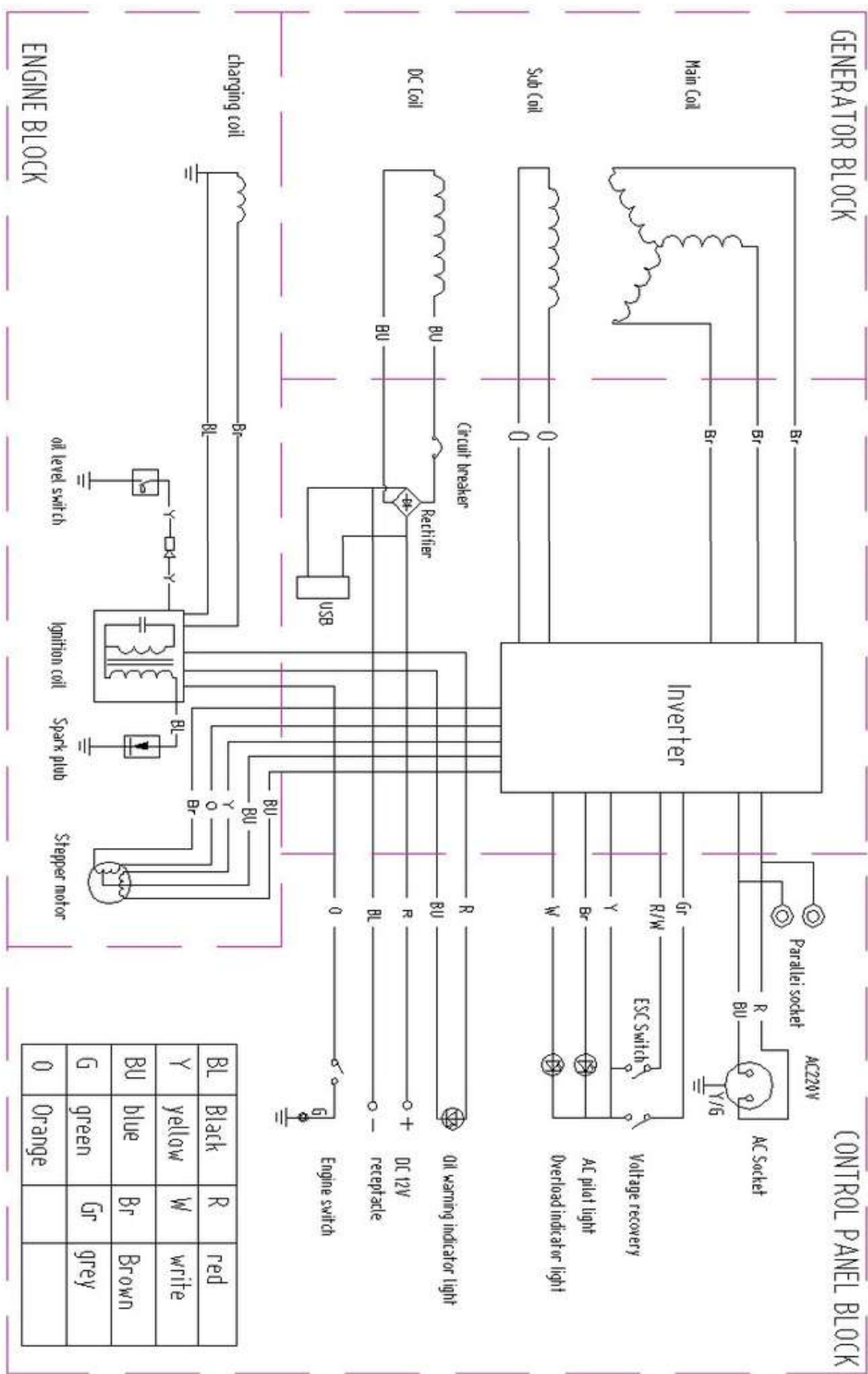

8.1 Warranty

Warranty Terms and Conditions

1. This warranty shall enter into force on the date stated on the original purchase invoice and shall remain valid for a period of twelve (12) months.
2. This warranty is non-transferable unless prior written consent has been obtained from the supplier.
3. Warranty claims will not be accepted without presentation of the original purchase invoice.
4. This warranty shall apply exclusively provided that the product has been used in full compliance with the instructions contained in the user manual and solely for its intended purpose.
5. No alterations, modifications, or technical changes may be made to the product.
6. This warranty shall be void in the event of improper, negligent, or incorrect use of the product.
7. Transportation, shipping, and related costs are expressly excluded from this warranty.
8. Any repair work must be carried out exclusively by the supplier or an authorised service partner. Repairs performed by unauthorised third parties shall immediately void all warranty rights.
9. Repairs performed during the warranty period shall not result in an extension of the original warranty period. However, a separate warranty period of three (3) months shall apply to the repaired components, provided that the original warranty period has expired.
10. All maintenance and servicing operations described in the user manual must be performed in a timely and proper manner. Failure to do so may result in the warranty becoming void.
11. Warranty claims may only be submitted to the original point of sale at which the product was purchased.

8.2 EC Declaration

***EG-verklaring van overeenstemming - Declaration of conformity –
Konformitätsverklärung - Declaration de conformite - Dichiarazione di
conformita- Declaracion de conformidad***

Wij, We,Wir,Nous,**Valkenpower BV, Haverkamp 11, 6051 AC Maasbracht, Nederland**, verklaren geheel onder eigen verantwoordelijkheid dat de producten, declare under our sole responsibility that the products, erklären in voller eigener Verantwortung, dass die Produkte, déclarons sous notre entière responsabilité que les produits

Type Model Art Type	Beschrijving Description Beschreibung Description	Merk Brand Marke Marque
EMI2300 EMI2300	Generator Générateur	Valkenpower Valkenpower

Waarop deze verklaring betrekking heeft, in overeenstemming zijn met de volgende normen:To which this declaration relates, are in conformity with the following standards:Auf die sich diese Erklärung bezieht, den folgenden Normen entsprechen:Auxquels la présente déclaration se rapporte, sont conformes aux normes suivantes

De machinerichtlijn: Following the provisions of Directive: Gemäß den Bestimmungen der Richtlinie: Conformément aux dispositions de la Directive:

2006/42/EG

2014/30/EU

2014/35/EU

Serienummer:
Serial number:

Directeur Valkenpower



B.A.H Valkenburg

Nederland, Maasbracht, 11-04-2023