



User Manual Blasting Cabinet Type SB99HP



Read this manual carefully before using the blast cabinet.

Table of contents	Page
1. Keeping the user manual	3
2. General description	4
3. Application and main features	4
4. Safety instructions	5
5. Symbols	6-7
6. Environment & disposal	7
7. Montage	8-10
8. Pneumatic panel connection	11
9. Mounting the elevation frame	11
10. Foot pedal connection	12
11. Mounting flange for dust extraction connection	12
12. Cyclone	12
13. Use	13
13.1 Operation	13
13.2 Points of attention	13
14. Maintenance	14
15. Technical specifications	14
16. Parts list	15
17. Left crossbar	16
18. Control panel	16
19. Tank	17
20. Switch box	18
21. Electrical diagram	18
22. Guarantee	19
23. EC Declaration	20

1. Keep the user manual

Keep this user manual in a safe place. The information in this document may be necessary for installation, operation, maintenance, or troubleshooting. Keep this manual accessible at all times for future reference. This user manual contains important safety instructions and legal information. Keep this document for the entire life of the product. Always provide this manual if the product is resold, transferred, or relocated. It is mandatory to keep this user manual in a centrally accessible location. Personnel who work with this product must have access to the most recent version of this documentation at all times.



Dispose of electrical appliances in an environmentally friendly manner. Do not dispose of electrical appliances with household waste. In accordance with European Directive 2012/19/EU on electronic appliances, they must be collected separately for recycling. Contact your local authorities for available disposal options for your worn-out appliance.

© 2026 Airpro All rights reserved. No part of this publication may be reproduced, stored in a retrieval system, or transmitted in any form or by any means without the express prior written permission of the publisher, except in cases where otherwise permitted by law.

2. General description

The AirPro SB99HP is an industrial sandblasting booth designed for effectively cleaning, derusting, or matting various workpieces. The machine operates on a pressure blast system, where the blast media is propelled under high pressure from a 22-liter blast pot to the nozzle.

3. Application and main features

Application:

Cleaning and derusting: Removing oxidation, paint residue or stubborn dirt from workpieces.

- Surface finishing: The matting or preparation of surfaces for further treatment.
- Use with various media: The machine is suitable for high-quality blast media such as aluminium oxide or glass beads (grain size 40-120 mesh), but definitely not for normal sand.

Key Features:

1. Powerful Pressure System

- Pressure vessel: Unlike simple injection systems, this machine operates with a 22-litre pressurised blast medium tank.
- Foot pedal control: The process is activated via a pneumatic foot pedal, which ensures a constant flow of air and abrasive to the nozzle.
- High Working Pressure: The machine functions optimally at a working pressure between 4.1 and 7.6 bar

2. Dust Control and Visibility

- Integrated Dust Extraction: The machine is equipped with an external dust collector with a power of 550 watts to filter dust directly from the cabin.
- LED Lighting: The interior is illuminated by three 20-watt LED lamps for maximum visibility while working.
- Large Viewing Window: Equipped with a replaceable protective film to prevent damage to the glass from reflecting abrasive.

3. Ergonomics and Safety

- Protection: The booth is fully enclosed and equipped with 24 inch sandblasting gloves to protect the operator from the powerful jet stream.
- Moisture separator: Equipped as standard with a moisture separator to prevent moisture in the compressed air from causing blockages in the blast media.
- Sturdy Base: The machine stands on a robust frame with legs and leg reinforcements for stability during industrial work.

4. Safety instructions

- Studying the Manual: Every blast cabinet generates a powerful stream of abrasive particles; therefore, the manual should be carefully studied before installation, commissioning, or maintenance.
- Direct exposure: Never expose hands or other parts of the skin directly to the jet from the nozzle during use.
- Post-assembly check: After assembly, check that all components are connected correctly and without leaks.
- Pressure limit: The maximum permissible working pressure of the blasting installation must never be exceeded.
- Disconnection for Maintenance: The machine must always be disconnected from the compressed air supply before replacing accessories, or before performing maintenance, moving, or repair.
- Hose Inspection: Before each use, all hoses and compressed air lines should be inspected for wear, weak spots, or damage.
- Connections: User must ensure that all connections are properly secured.
- Guidelines: The blast gun must never be pointed at persons, animals or unauthorized objects.
- Power Circuit: Before installation, verify that the required power circuit is available and within reach. If it does not meet specifications, a new circuit must be installed.
- Electrical safety: To minimize the risk of electrocution or fire, installation and electrical connection must only be carried out by a certified electrician or qualified personnel.
- Chemicals: Product or power cord may contain lead; always wash hands thoroughly after use.
- Dust Hazard: Dust from processed materials (such as wood, metal, concrete) may contain chemicals that are carcinogenic or harmful to reproduction.
- Protective clothing: Always wear protective clothing and respiratory protection.
- Fire hazard: Do not use the machine near flammable liquids, gases, or explosive materials. Blasting media such as aluminum oxide can generate static electricity.
- Grounding: Grounding must be established to prevent static shock by attaching a grounded wire to the mouthpiece holder.

5. Symbols



Read the instruction manual before use.



Wear ear protection when using.



Wear eye protection when using.



Unplug the appliance before performing any maintenance.



Wear protective gloves when using.



Wear a face mask when using.



Close the lid before use.



Warning: Electrical voltage



Warning: Crush hazard to hands.



Warning: Never exceed the maximum specified pressure.



No smoking or open flames in the area

6. Environment & disposal

Used blast media is considered waste and must be disposed of in accordance with applicable environmental and waste regulations. The disposal method depends on the type of blast media and the contamination created during blasting.

7. Montage

1. Mount the 4 legs to the frame with M8*20 bolts and tighten them.
2. Install two short leg reinforcements and two long leg reinforcements. Use M8*20 bolts, flat washers, lock washers, and M8 nuts and tighten them.

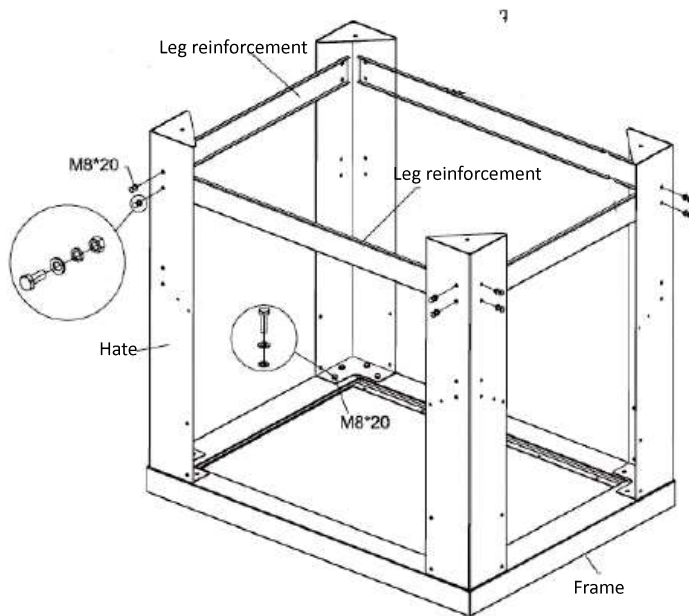

3. Turn the frame with the legs upside down and mount the control panel on the front, as shown in the figure. Use M6*12 and nuts.
4. Install the left intermediate support on the left side, where the breather damper is located. Use M6*12 mm bolts and nuts.
5. Install the rear and right intermediate supports. M6*12 bolts and nuts.

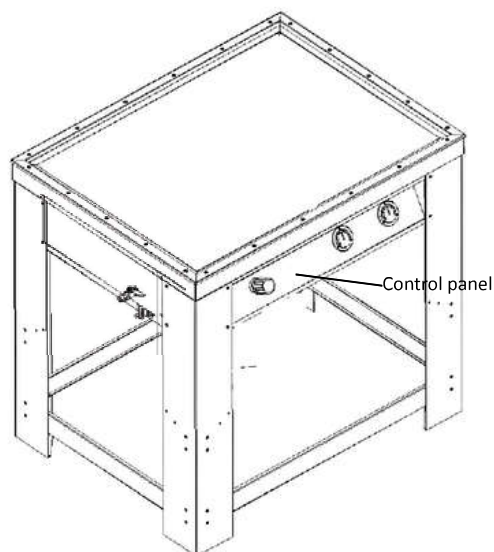

6. Install the suction hose to the cylinder block on the tank.

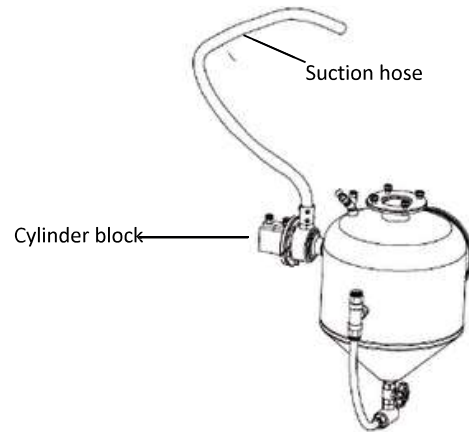

7. Place the funnel as shown in the image below.

8. Attach the tank to the funnel. Make sure the rubber seal is placed between the funnel and the tank. Secure the tank with M8*25 bolts, a flat washer, a lock washer, and nuts.

Note: Make sure the tank service port is on the right side of the funnel.

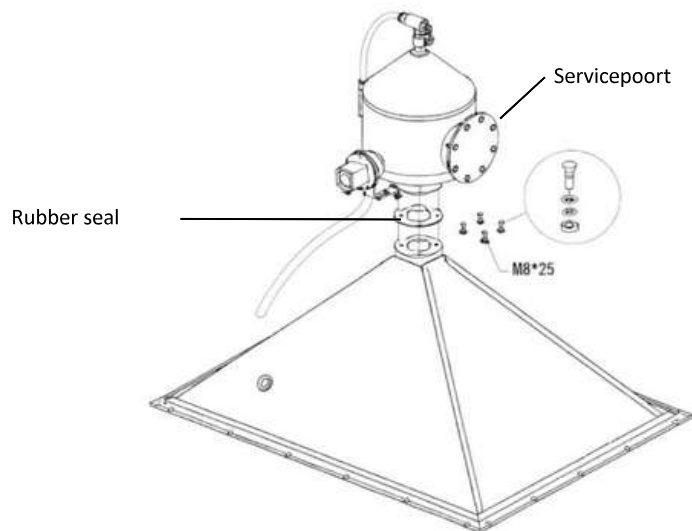

9. Turn the funnel with the pressure tank upside down and place it in the frame.

Please note: The cylinder block is located at the rear.

10. Insert the cylinder block intake hose through the rubber funnel hole. Tighten the hose to the T-piece under the pressure vessel.

11. Apply the self-adhesive foam seal all around the top edge of the funnel and place the grid lid in the funnel

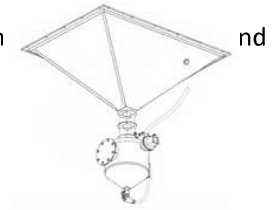
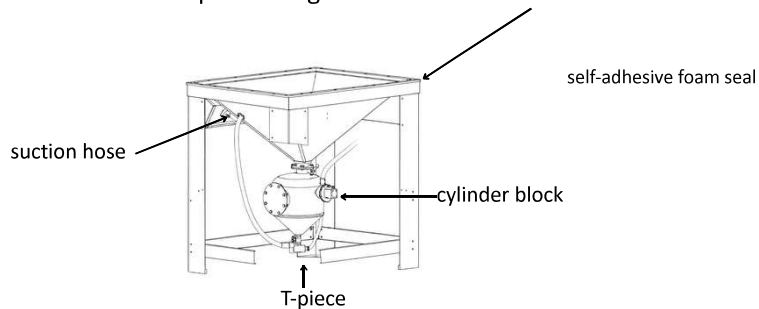

12. Insert the cylinder block intake hose into the protective cap

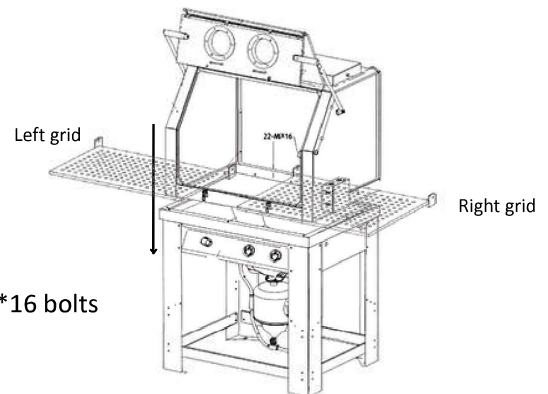
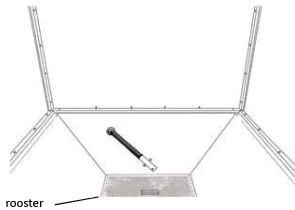

13. Place the cabin on top of the hopper and secure it with M6*16 bolts and a flat washer.

14. Place the left and right grilles in the cabin.

15. Remove the jet nozzle from the sand hose and then feed it through the rubber opening at the back of the cabin. Secure the hose with two clamps and apply sealing foam to the clamps.

16. Finally, place the blast head back on the sand hose and secure the gun with screws.

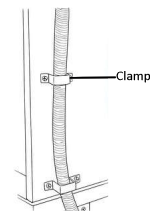

8. Connection pneumatic panel

1. The 3/2 way solenoid valve has three 8mm hoses, orange H2, blue H3 and one short orange hose connected to the aluminium valve body.
 - Connect the orange H2 hose to the front connection C2 of the tank cylinder block.
 - Connect the blue H3 hose to the rear connection C3 of the tank cylinder block.
2. Connect the orange H4 (16mm) hose attached to the outgoing port (A) of the solenoid valve to the brass T-connector on the pressure vessel.
3. Connect the orange H1 (8mm) hose from the pneumatic panel feed-through to the connecting nipple on the pressure vessel.
4. Connect the blue hose from the bleed damper to the aluminum valve body.

Note: Push the hoses fully into the push-in coupling and pull lightly to check for security.

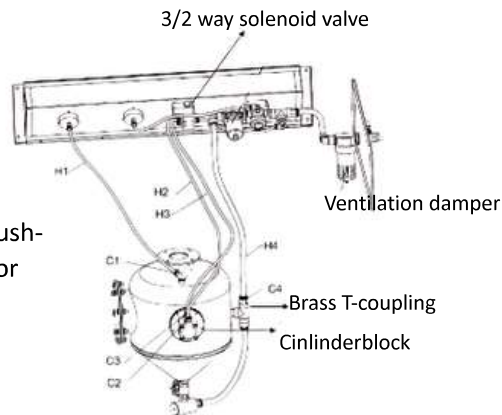

9. Mounting the elevation frame

1. Assemble the riser frame using M8*45mm bolts, M8 nuts, 8 flat washers, and 8 lock washers. See image.

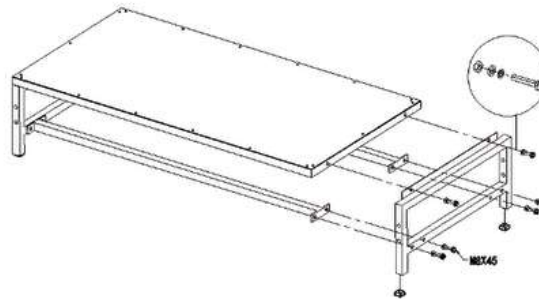

2. Install the riser frame to the cabinet's front legs as shown in the image. Assemble the riser frame with M8*45mm bolts, M8 nuts, 4 flat washers, and 4 lock washers.

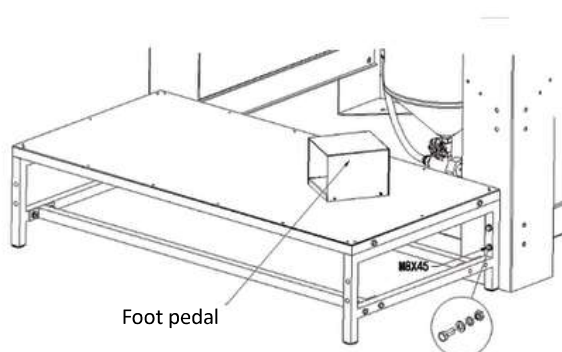

10. Foot Pedal Connection

Plug the electrical plug for the solenoid valve and the connection plug for the foot pedal into the power supply.

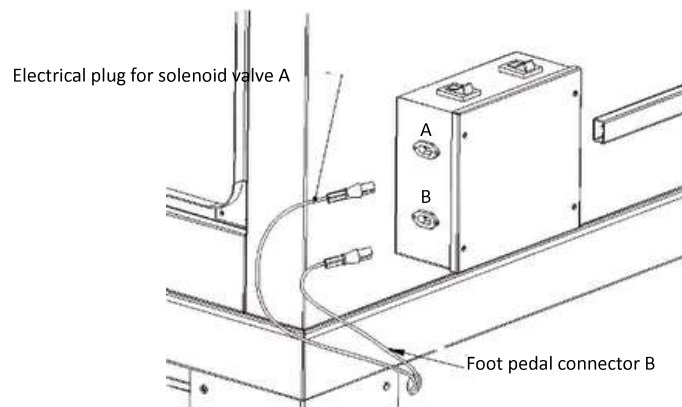

11. Mounting flange for connecting dust separator

Attach the large flange to the back of the Cabin with 4 x M6*12mm screws.



12. Cyclone

Mount the dust collection container at the bottom of the cyclone and connect it as a whole to the vacuum system.

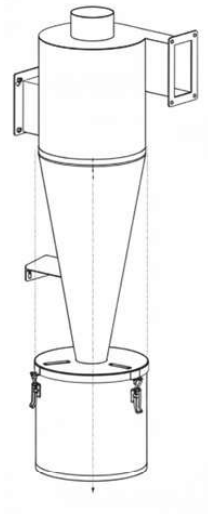

13. Use

1. Connect the air and power supplies and open the control door;
2. Load the blast media;
3. Place the workpiece on the rack;
4. Lock the door and turn on the dust extraction;
5. Open the air inlet valve;
6. Set the operating pressure and press the foot pedal to start.

13.1 Operation

- Pressing the foot pedal releases air into the pressure vessel, closing the sealing head and allowing the abrasive to flow through the hose. Opening the valve on the vessel regulates the amount of abrasive.
- Open the valve slowly until the desired jet stream is reached.
Caution: A valve that is opened too far can cause pulsation and clog the mouthpiece.
- To bleed the boiler, close the air inlet and press the foot pedal until the pressure gauge reads zero.
- When the foot pedal is in the rest position, the air flow to the sealing head stops and the abrasive returns to the tank.

13.2 Points of attention

- Before use, check the seals on valves, connections, and hoses. Replace if necessary.
- Filter the blast media through a sieve to keep dirt particles out of the boiler, valve or nozzle.
- Don't add too much abrasive. An overfilled boiler can cause a leak at the sealing head.
- When the abrasive stops flowing, release the foot pedal to allow the abrasive to flow back into the pressure vessel.
- Use clean, dry, and reusable high-quality abrasive. Moisture causes blockages and flow problems. Replace worn abrasive. DO NOT USE SAND.
- To change the abrasive: Place the nozzle in a woven bag and press the foot pedal until all the abrasive is out of the machine.
- Drain the water separator reservoir as needed, at least 1-2 times per day.
- Clean the dust extraction filters as needed. In dusty conditions, this may be several times every six hours.
- Neglect may cause the engine to overheat, which is not covered by the warranty.
- Perform regular inspections on the sealing head for wear, deformation or leakage.
- Clean all abrasive after use to avoid malfunctions next time.
- Store the abrasive in a dry place.
- Prevent clogging: keep the blast media dry.
- The nozzle should be 3-4 times larger than the grain size of the blast media.

14. Maintenance

Caution: Disconnect power and air supply before performing any maintenance.

Cleaning: Clean the machine or its parts with a soft cloth. DO NOT use solvents.

15. Specifications

Maximale luchtdruk:	7,6 bar
Luchtverbruik:	708 liter/minuut bij 5 mm mondstuk en 5,5 bar
Totale afmetingen:	1740 mm (B) × 2010 mm (H) × 1320 mm (D) (met geopende deur: 2415 mm hoog)
Werkdruk:	4,1 – 7,6 bar
Straalslang:	Ø25,4 mm buitenmaat-Ø12,7 mm binnenmaat
Korrelgrootte schuurmiddel:	40-120 mesh (ca. 400-125 micron)
Tankinhoud:	22 liter
Tankafmetingen:	307 mm × 406 mm
Motorvermogen:	550 watt
Werklamp:	LED-verlichting, 3 lampen van elk 20 watt

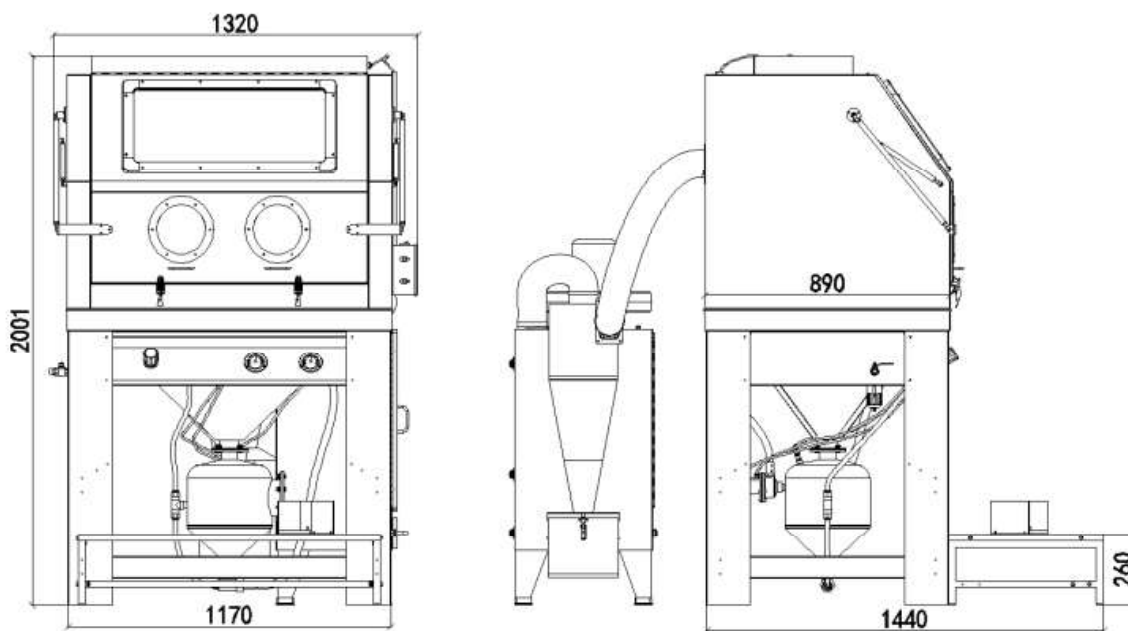

16. Parts List

1. PSB99HP1-01 Kabinetmontage
2. PSB99HP1-02, Linker rooster
3. PSB99HP1-03 Right grille
4. PSB99HP1-04, Hexagon bolt M6x16 with washers $\varnothing 6 \times 16$
5. PSB99HP1-05 Sealing felt
6. PSB99HP1-06 Mounting bracket
7. PSB99HP1-07 Roosterafdekking
8. PSB99HP1-08 Funnel (collection)
9. PSB99HP1-09 Rear connecting rod
10. PSB99HP1-10 Left cross member
11. PSB99HP1-11 Hexagon bolt M6x12
12. PSB99HP1-12 Control Console
13. PSB99HP1-13 Blasting Media Tank
14. PSB99HP1-14 Right cross member
15. PSB99HP1-15 Hexagon bolt M8x20
16. PSB99HP1-16 Leg
17. PSB99HP1-17 Leg brace
18. PSB99HP1-18 Leg brace
19. PSB99HP1-19 Chassis
20. PSB99HP1-20 Foot control (pedal)
21. PSB99HP1-21 Hexagon bolt M8x45
22. PSB99HP1-22 Dust collector
23. PSB99HP1-23 Suction hose (vacuum)
24. PSB99HP1-24 Install closing flange
25. PSB99HP1-25 Hexagon bolt M6x32
26. PSB99HP1-26 Window frame
27. PSB99HP1-27 Outer window plate
28. PSB99HP1-28 Inner window plate
29. PSB99HP1-29 Window Protective Film
30. PSB99HP1-30 Sealing felt for viewing window
31. PSB99HP1-31 Rubber door seal
32. PSB99HP1-32 Luminaire housing
33. PSB99HP1-33 LED-lamp
34. PSB99HP1-34 Light lens
35. PSB99HP1-35 Light lens sealing
36. PSB99HP1-36 Rubber ring for light lens
37. PSB99HP1-37 Top cabinet mounting
38. PSB99HP1-38 Switchbox
39. PSB99HP1-39 Handle
40. PSB99HP1-40 Glove clip
41. PSB99HP1-41 Sealing ring for glove
42. PSB99HP1-42 Front panel (with door)
43. PSB99HP1-43 Front cross member
44. PSB99HP1-44 Sandblasting glove 24"
45. PSB99HP1-45 Gauntlet cuff
46. PSB99HP1-46 Nozzle nut
47. PSB99HP1-47 Nozzle
48. PSB99HP1-48 O-ring
49. PSB99HP1-49 Nozzlehouder
50. PSB99HP1-50 Adapter for nozzle holder
51. PSB99HP1-51 Self-tapping screw 4.2x12
52. PSB99HP1-52 Blasting hose
53. PSB99HP1-53 T-piece coupling

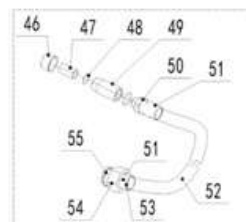
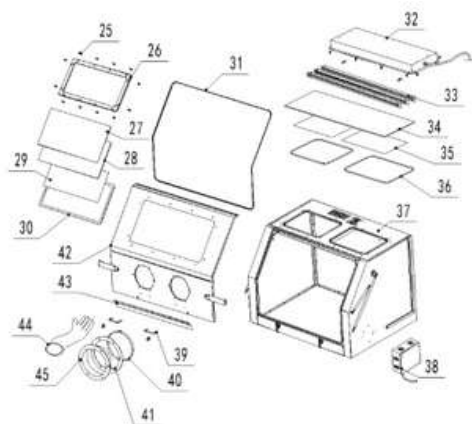
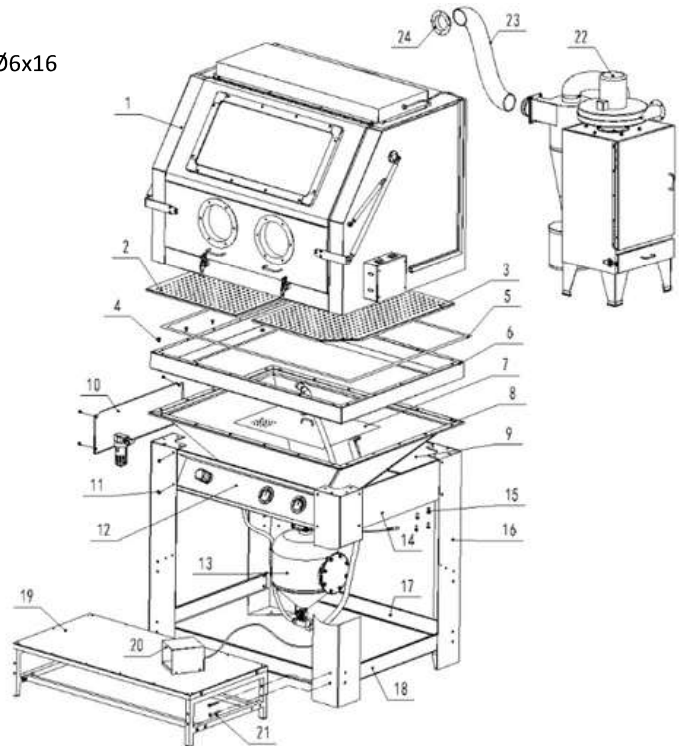

17. Left crossbar

1. PSB99HP2-01 Left cross member
2. PSB99HP2-02 Straight air hose coupling
3. PSB99HP2-03 stainless steel ball valve
4. PSB99HP2-04 Circlip
5. PSB99HP2-05 Moisture separator
6. PSB99HP2-06 Rectangular quick coupling
7. PSB99HP2-07 Air hose

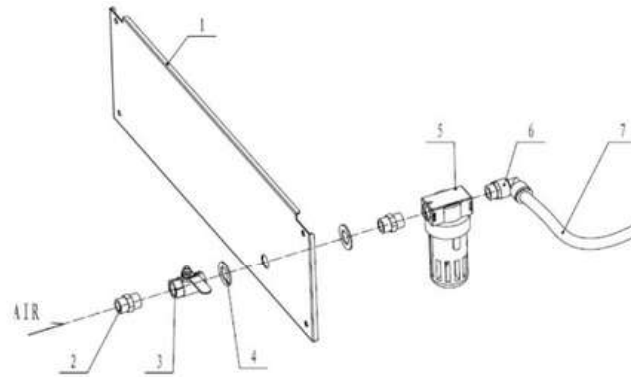

18. Control console

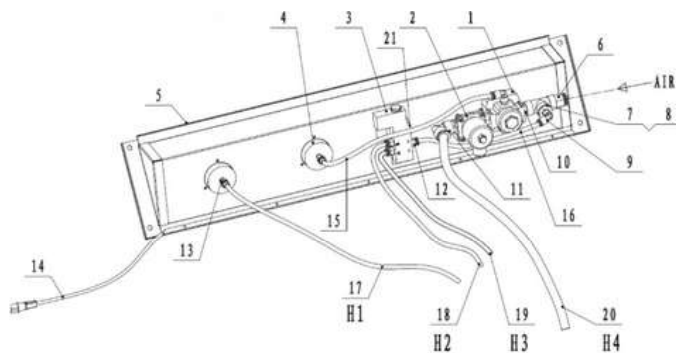

1. PSB99HP3-01 Pressure regulator
2. PSB99HP3-02 Electromagnetic valve 1
3. PSB99HP3-03 Electromagnetic valve 2
4. PSB99HP3-04 Manometer
5. PSB99HP3-05 Control Console
6. PSB99HP3-06 Straight coupling G1/2"-16
7. PSB99HP3-07 T-stuk
8. PSB99HP3-08 G1/2"-G1/4" internal thread
9. PSB99HP3-09 Straight coupling G1/4"-8
10. PSB99HP3-10 Straight coupling G1/2"
11. PSB99HP3-11 Straight coupling G1/2"-16
12. PSB99HP3-12 Straight coupling G1/4"-8
13. PSB99HP3-13 Manometerkoppeling M10*11-8
14. PSB99HP3-14 Electromagnetic adhesive cables
15. PSB99HP3-15 Air line Ø8
16. PSB99HP3-16 Air line Ø8
17. PSB99HP3-17 H1_Air hose Ø8
18. PSB99HP3-18 H2_Air hose Ø8
19. PSB99HP3-19 H3_Luchtslang Ø8
20. PSB99HP3-20 H4_Luchtslang Ø16
21. PSB99HP3-21 Silencer G1/8"

19. Tank

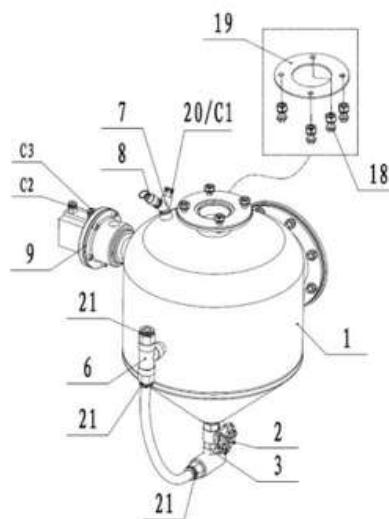
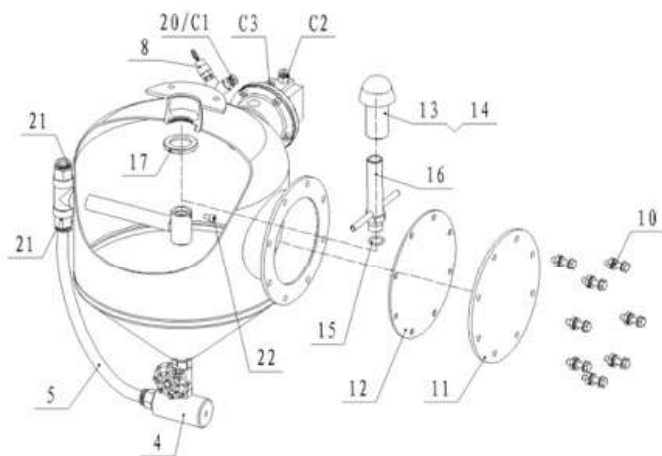

1. PSB99HP4-01 Blasting medium tank
2. PSB99HP4-02 Gate valve
3. PSB99HP4-03 Straight coupling G1/2"
4. PSB99HP4-04 Abrasive Tee Connection
5. PSB99HP4-05 Air hose Ø16
6. PSB99HP4-06 T-connector G1/2"
7. PSB99HP4-07 Y-connector G1/4"
8. PSB99HP4-08 Safety valve
9. PSB99HP4-09 Cylinder block
10. PSB99HP4-10 Hexagon bolt M8x30
11. PSB99HP4-11 Service opening cover
12. PSB99HP4-12 Gasket service opening
13. PSB99HP4-13 Sealing head
14. PSB99HP4-14 Rigid pipe
15. PSB99HP4-15 O-ring
16. PSB99HP4-16 Inlet Welding Assembly
17. PSB99HP4-17 Flat washer
18. PSB99HP4-18 Hexagon bolt M8x25
19. PSB99HP4-19 Rubber gasket
20. PSB99HP4-20 Straight coupling G1/4" (C1)
21. PSB99HP4-21 Straight coupling G1/8" (C2)
22. PSB99HP4-22 Right coupling G1/8" (C3)
23. PSB99HP4-23 Straight coupling G1/2"-16
24. PSB99HP4-24 Hexagon bolt M6x10

20. Switch box

1. PSB99HP5-01 Control cabinet housing
2. PSB99HP5-02 Switch
3. PSB99HP5-03 Socket (2-pole)
4. PSB99HP5-04 Locking buckle
5. PSB99HP5-05 Fuse holder
6. PSB99HP5-06 Fuse
7. PSB99HP5-07 Power cord
8. PSB99HP5-08 Socket (3-pole)
9. PSB99HP5-09 Switch cabinet cover
10. PSB99HP5-10 Self-tapping screws 4.2x10
11. PSB99HP5-11 Power cord or lamp connection

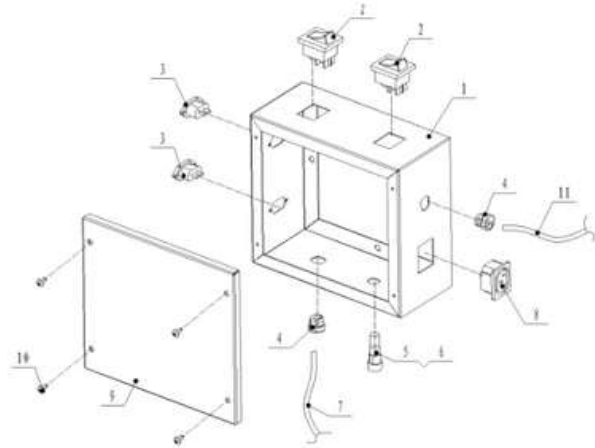

21. Electrical diagram

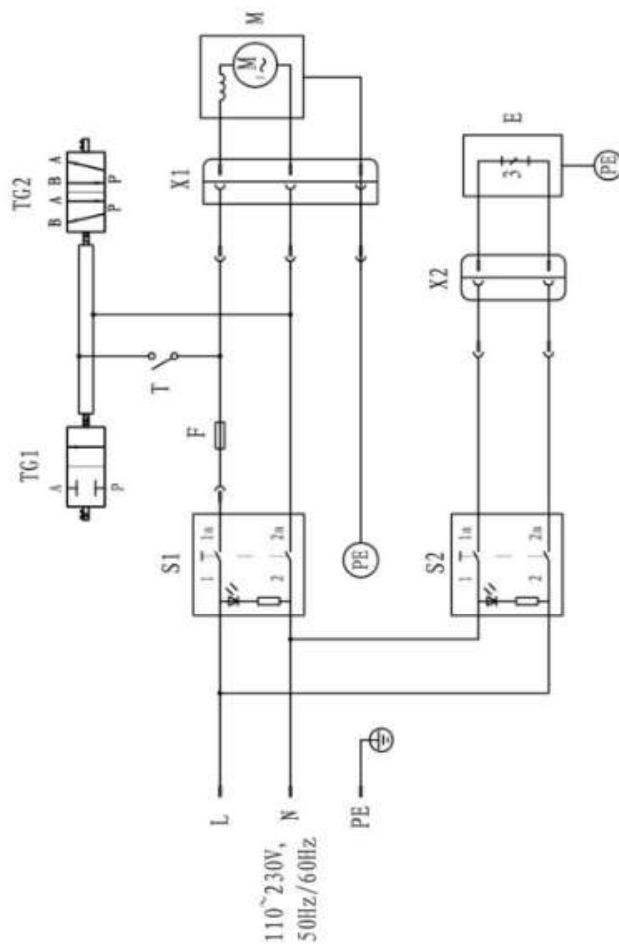

- L → Phase
- N → Neutral
- PE → Earth (Protective Earth)
- F → Fuse
- E → LED
- X1 / X2 → Connector
- S1 / S2 → Motor contactor
- M → Motor
- T6 / T2 → Solenoid valve switch
- T → Foot switch

21.Warrantly

Warranty Terms and Conditions

1. This warranty shall enter into force on the date stated on the original purchase invoice and shall remain valid for a period of twelve (12) months.
2. This warranty is non-transferable unless prior written consent has been obtained from the supplier.
3. Warranty claims will not be accepted without presentation of the original purchase invoice.
4. This warranty shall apply exclusively provided that the product has been used in full compliance with the instructions contained in the user manual and solely for its intended purpose.
5. No alterations, modifications, or technical changes may be made to the product.
6. This warranty shall be void in the event of improper, negligent, or incorrect use of the product.
7. Transportation, shipping, and related costs are expressly excluded from this warranty.
8. Any repair work must be carried out exclusively by the supplier or an authorised service partner. Repairs performed by unauthorised third parties shall immediately void all warranty rights.
9. Repairs performed during the warranty period shall not result in an extension of the original warranty period. However, a separate warranty period of three (3) months shall apply to the repaired components, provided that the original warranty period has expired.
10. All maintenance and servicing operations described in the user manual must be performed in a timely and proper manner. Failure to do so may result in the warranty becoming void.
11. Warranty claims may only be submitted to the original point of sale at which the product was purchased.

23. EG-Verklaring

EG-verklaring van overeenstemming - Declaration of conformity – Konformitätsverklärung - Declaration de conformite - Dichiarazione di conformita- Declaracion de conformidad

Wij, Valkenpower BV, Haverkamp 11, 6051 AC Maasbracht, Nederland, verklaren geheel onder eigen verantwoordelijkheid dat de producten

We, Valkenpower BV, Haverkamp 11, 6051 AC Maasbracht, Nederland, declare under our sole responsibility that the receiver

Wir, Valkenpower BV, Haverkamp 11, 6051 AC Maasbracht, Nederland, erklären in alleiniger Verantwortung, daß der Behälter

Nous, Valkenpower BV, Haverkamp 11, 6051 AC Maasbracht, Nederland, déclarons sous notre seule responsabilité que le réservoir

Noi, Valkenpower BV, Haverkamp 11, 6051 AC Maasbracht, Nederland, dichiariamo sotto la nostra responsabilità che

La empresa, Valkenpower BV, Haverkamp 11, 6051 AC Maasbracht, Nederland, declara, bajo su responsabilidad, que

Type	Beschrijving	Merk
Model	Description	Brand
Art	Beschreibung	Marke
Type	Description	Marque
Modelo	Descripción	Marca
SB99HP	Zandstraalkast	Airpro
SB99HP	Sandblasting cabinet	Airpro
SB99HP	Sandstrahlkabine	Airpro
SB99HP	Cabine de sablage	Airpro

Waarop deze verklaring betrekking heeft, in overeenstemming zijn met de volgende normen:

To which this declaration relates is in conformity with the following document:

Auf dem sich diese Erklärung bezieht, mit dem folgendem Dokument übereinstimmt:

Auquel se réfère cette déclaration est conforme à le document suivant:

A cui si riferisce dichiarazione, corrisponde ai seguenti documenti: Attestazione CE di tipo

Al que se refiere la presente declaración, corresponde a los siguientes documentos:

De machinerichtlijn: 2006/42/EG; 2014/68/EU

Following the provisions of Directive: 2006/42/EG;2014/68/EU

Gemäß den Bestimmungen der Richtlinie: 2006/42/EG;2014/68/EU

Conformément aux dispositions de la Directive: 2006/42/EG;2014/68/EU

Conforme con la norma: 2006/42/EG;2014/68/EU

Serienummer:
Serial number:

Directeur Valkenpower



Nederland, Maasbracht, 03-06-2025

B.A.H Valkenburg